

Fruit Tree Display – Permie Backyard Display

These trees are from Tass1Trees and were loaned to allow us to set up a food forest. Joe has a rare fruit and nut nursery, WA's largest range of Fruit and Nuts trees, at 1072 Great Northern Highway, Baskerville WA 6056. Joe : 0419 988 344

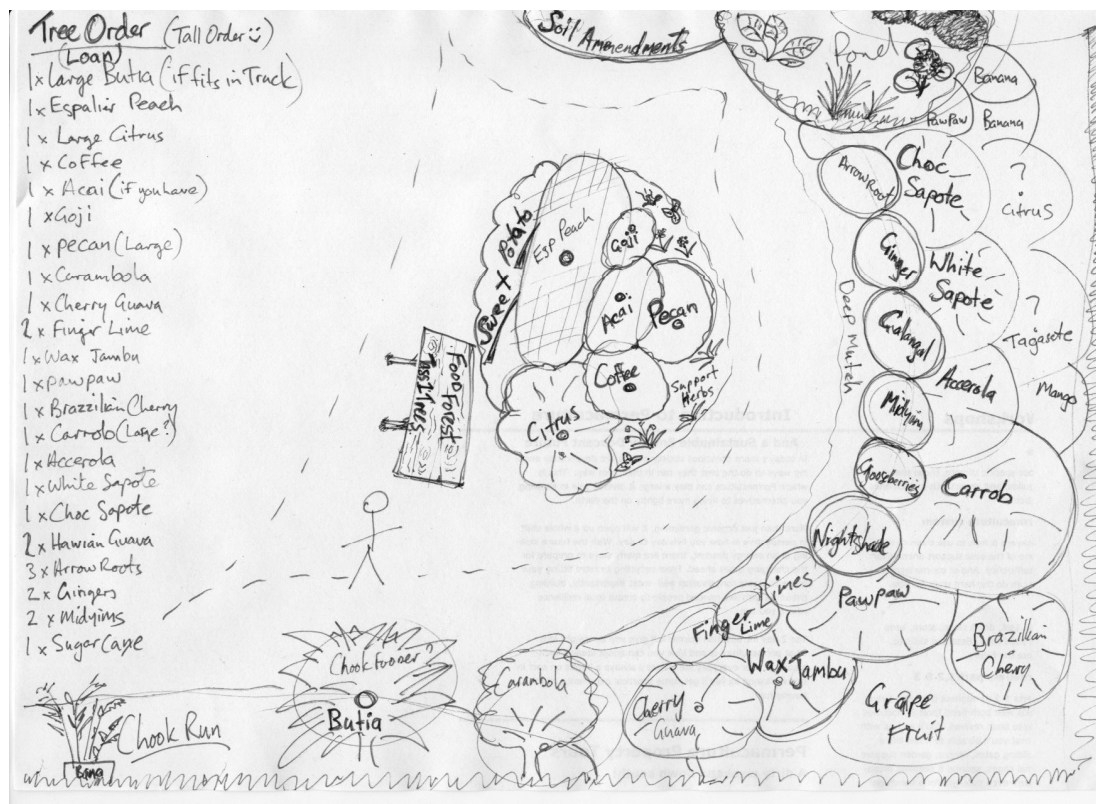

- BUTIA Palm or Jelly Palm or Wine Palm – Hardy rounded palm producing lots of edible orange fruit. Full sun exposed is ok.
- PEACH – Peaches are deciduous, get a low chill one so it bears and keep it small so you can fruit fly net it. Joes fancy espalier is a dual graft also, so cross pollination on the same plant.
- LEMON – Evergreen, 2-3 high bush, great for flower fragrance and lemons.
- COFFEE – Evergreen 1m Understory plant, locate in shaded posy.
- GOJI BERRY - Evergreen 1m Understory plant, locate in shaded posy.
- PECAN NUT TREE – Deciduous, tall 6-10 meters, edible nuts, if you beat the bird.
- CARAMBOLA – Star Apple 3-4 m evergreen tree, sets fruit over much of the year, response well to cow manure.
- FEIJOA – Pineapple Guava 2-3m Evergreen, might need fruit fly protection. Good dense hedging plant.
- CHERRY GUAVA – 2-3m small tasty fruit, everyone should have one, eat at tree (think berries), Fruit fly net needed.
- FINGER LIME – Selectively bred native lime, finger shaped fruit loose caviar citrus bits, spiky, can be kept small. Makes great keep out hedge.
- WAX JAMBU – Evergreen, Larger tastier version of a lillypilly, bell shaped fruit, fruit fly net needed.
- BRAZZILIAN CHERRY – Evergreen bushy tree, 3-4 meters. Nice sour tasting cherry equivalent for low chill areas.



- CAROB – Get one or two, needs male and female (female has pods), tree fixes nitrogen, leaves a high protein fodder, edible wholesome pods.
- ACCEROLA – Barbados cherry, another low chill cherry like plant, 3 meters might need to fruit fly net
- WHITE SAPOTE – Evergreen Vigorous growing, 4mx4m tree, evergreen, great garden fruit, but doesn't keep well so not often sold commercially.
- CHOC SAPOTE – Same common name as above but different tree, like a persimmon, tree likes water and shade, needs protection and understory forest habitat. Great looking shinny leaves.
- INDIAN GUAVA – 3x3m evergreen tree, large yellow/orange foliage, might need fruit fly net
- HAWIAN GUAVA - 3x3m evergreen tree, large yellow/orange foliage, might need fruit fly net
- ARROWROOT – Looks like a Canna Lilly, its edible one with big root, great 'chop and drop' mulch. Tubers can be boiled or baked or pounded to release arrowroot milk. This is intern dried and forms flour.
- CARDAMON GINGER – Rhizome based knee high plant, leaves can be used to wrap Asian rice dishes.
- JABOTICABA – Ever green, Slow growing fruit tree, grows fruit direct on branches/trunk.
- SML LEAF TAMARIND - Small evergreen tree 7-8m, providing a beautiful rich green spreading crown. Interesting fruit from which the bright red-coated seeds emerge in mid summer, tasty tangy fruit.
- BUNYA NUT – Very large, 10 m plus, ever green pine, good on a farm, no good urban, pine cones might weight 5kg each.
- KEI APPLE – Spiky, bushy hedge yields sour but tasty yellow apples. Good for protecting something
- JUBJUBE – Chinese Date, great hardy resilience plant. Keep small 3m wide - 2m,high and is deciduous,
- DRAGON FRUIT – Cactus based edible fruit, compute at night so ne bees
- ROSE APPLE = As for wax jambu.
- ROSAVAYA POMEGRANATE – Pomegranate very hardy to 1.0 meters you should be able to keep them low. Watch fruit split with winter rain.
- BURDEKIN PLUM – 10-15m evergreen, hardy native, fruit needs to be ripened after picking.
- GRUMICHAMA - 10 meters height, bears small [fruits](#) that are purple to black in color, and have a sweet [cherry](#)-like flavor. Its wood is used in [carpentry](#), [woodworking](#) and [turnery](#).
- MIDYIM BERRY – Short prostrate native berry, bush tucker, good short edible hedge
- **Missing from our food forest but great.**

Pistachio, pawpaw (papaya), Ice-cream Bean, Cocoa, Cassava, Pandan, Nectarine, Apricot, Almond, Walnut, Mulberry, and many more.

